

# 30mm Brushless DC -With Internal Drive



## Specifications:

### General Specifications

Number of phases	3
Number of poles	2
Operating temperature range	-30°C ~ 85°C
Commutation	Electrically commutated
Bearing type	Shielded ball bearings
Housing material	Black anodized aluminum
Magnet material	Sintered Nd-Fe-B
Direction of rotation	Reversible
Insulation Class	Class B (130°C max.)
Dielectric strength	500 VDC for one minute
Insulation resistance	100Mohms min., 500VDC

Model		DM3037-24-001-01-I				
Nominal Voltage	V	24				
Rated Speed	RPM	1411				
Rated Current	A	0.15				
Rated Torque	mNm	5.77				
Rated Efficiency	%	28				
Phase Resistance	R	102				
Output Power	W	0.9				
Max. Efficiency	%	28				
No-Load Speed	RPM	3020				
No-Load Current	A	0.052				
Stall Torque	mNm	10.84				
Friction Torque	mNm	3.07				
Back EMF Constant	mV/RPM	6.19				
Torque Constant	mNm/A	59.12				
Slope of Speed vs. Torque Curve	RPM/mNm	278.71				
Mechanical time Constant	mS	19.79				
Rotor Inertia	g-cm <sup>2</sup>	6.78				
Max. Angular Acceleration	10 <sup>3</sup> rad/s <sup>2</sup>	15.98				
Sensor		Hall Sensor				
Driver Recommendation		DR3002IE				
Weight	g	110				
Motor Body Length	"L"	37				

## Outline Drawing

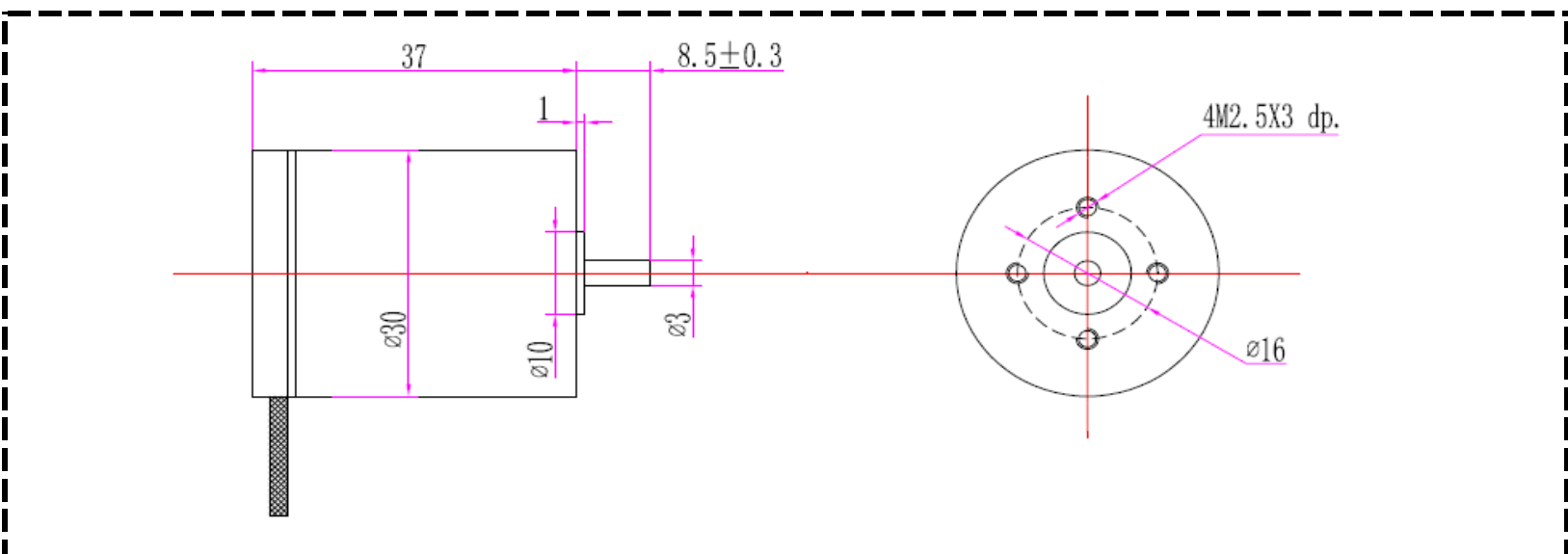

# Performance Curve

