

DC Coreless Motor

General Specification

Maximum Sleeve Bearing Loads

Axial (Dynamic)	≤2.4N
Radial (4mm From Jamming Ring)	≤28N
Press-Fit Force (Static)	≤110N
Axial Play (Measured Under Less Than 4N Axial Force)	0.05 - 0.15mm
Maximum Radial Play	0.025mm

Maximum Allowable Screw Depth into flange 2.5mm

Motor data (at 25°C)

		CD36-4112	CD36-4215	CD36-4524	CD36-4530	CD36-4236	
Assigned power rating	W	41	42	45	45	42	
Nominal voltage	V	12	15	24	30	36	
Terminal resistance ±10%	Ω	0.561	0.692	1.4	2	2.90	
No load speed ±10%	rpm	6010	6260	6130	6090	6220	
No load current	mA	248	190	56.5	53.9	49.6	
Speed constant	rpm/V	501	417	255	203	173	
Torque constant	mN.m/A	18.86	22.69	37.28	46.9	55.08	
Starting current	mA	21390	21676	17143	15000	12414	
Stall torque	mN.m	403.32	491.89	639.13	703.43	683.71	
Max. efficiency	%	80	82	89	88	88	
Limits for continuous operating range	Current	mA	4270	3364	2135	1682	1324
	Torque	mN.m	80.51	76.34	79.6	78.88	72.92
	Speed	rpm	4810	5288	5367	5407	5557
	Output power	W	40536	42255	44711	44641	42410
Max. permissible winding temperature	°C	+85	+85	+85	+85	+85	
Ambient temperature range	°C	-20 -- +65	-20 -- +65	-20 -- +65	-20 -- +65	-20 -- +65	
Weight	g	338	340	340	340	340	

Representative drawings and performance Curve

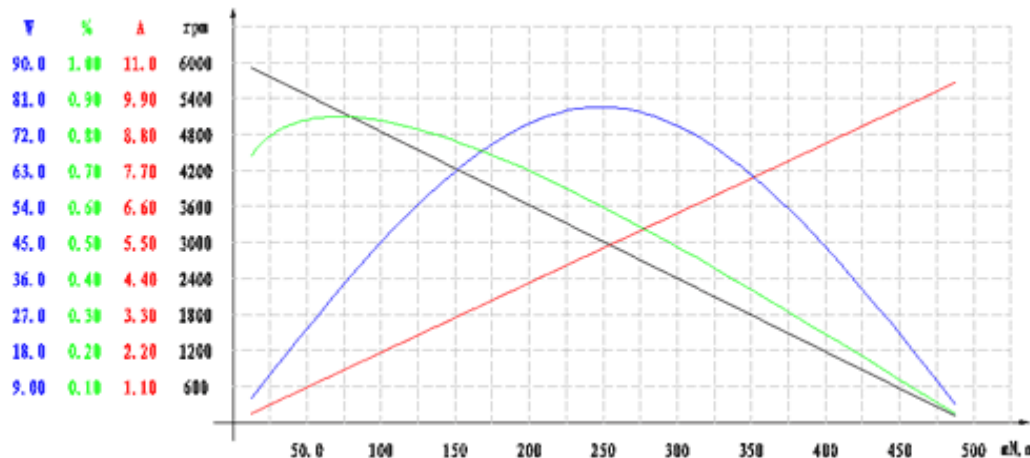
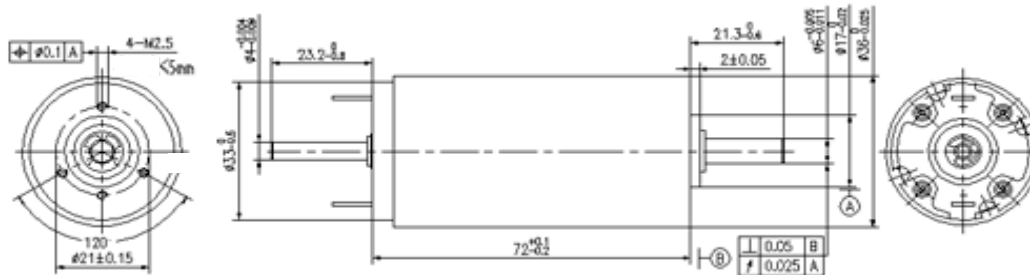

Note

1. Motor data tested at ambient temperature 25°C. Data varies when the temperature changes.
2. Motor service life different from operating conditions. In common condition, service life is achievable between approx. 1000 to 3000 hours.
3. Excessive bending of motor terminals may result in breakage when more than 3 times.