

4T2018 Series



Specifications

2-phase High Torque Stepping Motors (Frame Size: 20mm, NEMA Size 10)

Part #	Step Angle (degrees)	Leads	Holding Torque Minimum (Kg-cm)	Voltage (Volts)	Rated Current (A/Ph.)	Resistance (Ohms/Ph.)	Inductance (mH/Ph.)	Rotor Inertia (g-cm ²)	Motor Weight (grams)
4T2018S0604	1.8	4	0.18	3.9	0.60	6.5	1.7	2X10 ⁻⁷	60
4T2018M0604	1.8	4	0.18	3.9	0.60	6.5	1.7	2X10 ⁻⁷	60
4T2018L0604	1.8	4	0.30	4.32	0.80	5.4	1.5	2X10 ⁻⁷	80

Outline Drawing

4T2018 Standard Torque Stepper (Shown with optional rear shaft and encoder mounting holes)

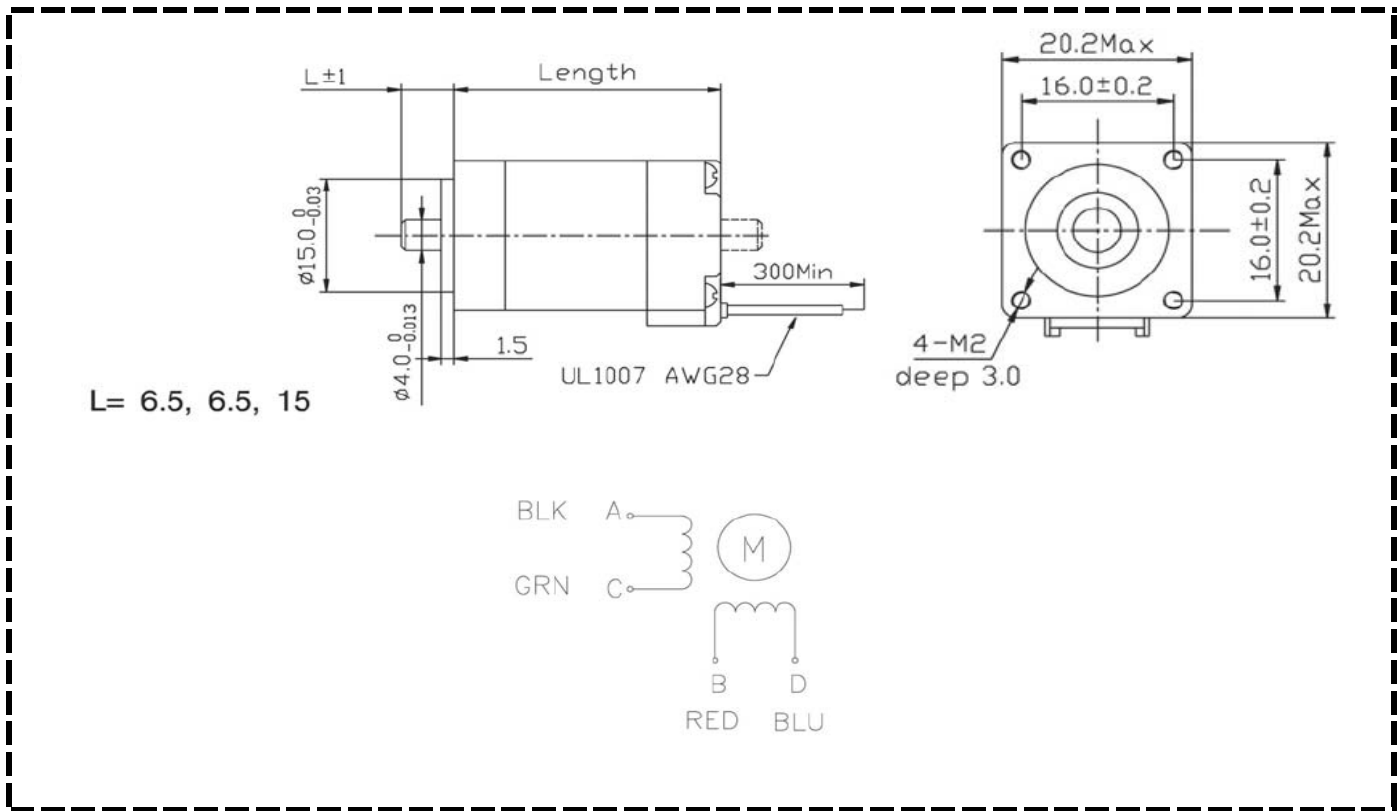

SPEC.	DIM. "L"
S	30
M	33
L	42

