

# Micro BLDC Motor

# 56mm

Frame Size	56 mm
Efficiency	70 ~ 90%
Max. Rated Speed	3520 RPM
Max. Rated Torque	250 mNm / 35.4 oz-in
Max. Rated Output Power	92.1 W
Noise Level	<55 dB
Operating Temperature	- 10 ~ 40 °C
Weight	400, 570g
Options	Gearbox, integrated driver



## Application:

- Electric toothbrush, electric shaver, hair clipper, noodle maker, audio and visual equipment

## Specifications:

Part Number	Motor Body Length (mm)	No Load			Rated				Starting	
		Rated Voltage (VDC)	Speed (RPM)	Current (A)	Current (A)	Speed (RPM)	Torque (oz-in)	Output power (W)	Current (A)	Torque (oz-in)
DM5665-12-039-02	65	12	3610	0.98	4.88	2500	21.24	39.2	8	40.5
DM5665-24-060-03	65	24	3600	0.45	3.84	3000	26.91	60	8	69.39
DM5665-36-060-03	65	36	4350	0.38	2.22	3210	25.49	60.5	5	65.71
DM5665-48-066-02	65	48	4080	0.27	1.84	2900	31.15	66.8	5	94.46
DM5685-12-030-02	85	12	3025	1.01	3.45	2340	17.14	30	8	51.41
DM5685-24-077-02	85	24	4660	0.86	4.7	2980	35.36	77.9	8	67.97
DM5685-36-080-03	85	36	4800	0.53	3.14	3080	35.4	80.7	5	63.3
DM5685-48-092-03	85	48	5410	0.44	2.65	3520	35.4	92.1	6.74	101.11

## Mechanical Drawing:

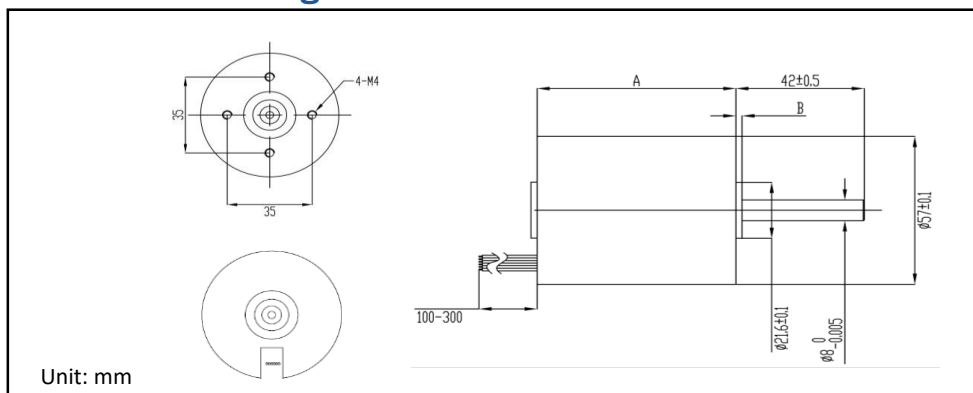

DM5665-XX-XXX-XX	
A	56
B	2

DM5685-XX-XXX-XX	
A	85
B	1.5

## Telco Intercontinental Corp.

9812 Whithorn Drive  
Houston, TX 77095  
www.telcointercon.com

sales@telcointercon.com  
(281) 855-2218



A division of TELCO

# Micro BLDC Motor

# 56mm

## Performance Curves:

DM5665-24-060-03

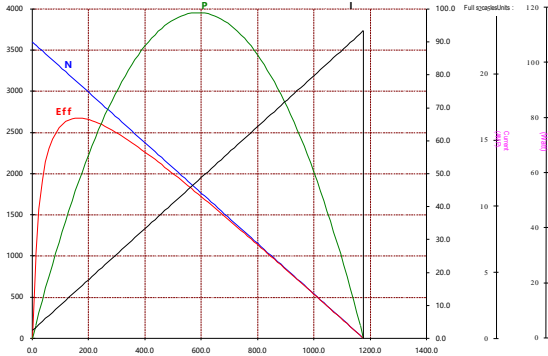

DM5665-36-060-03

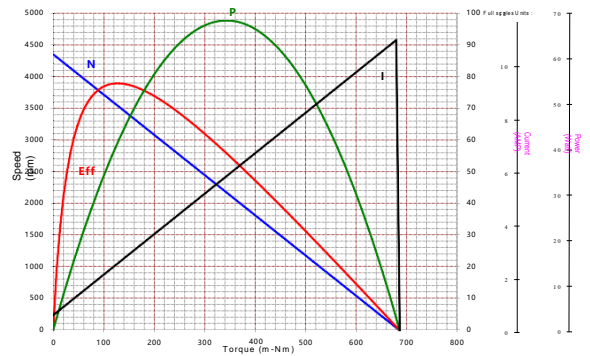

DM5685-24-077-02

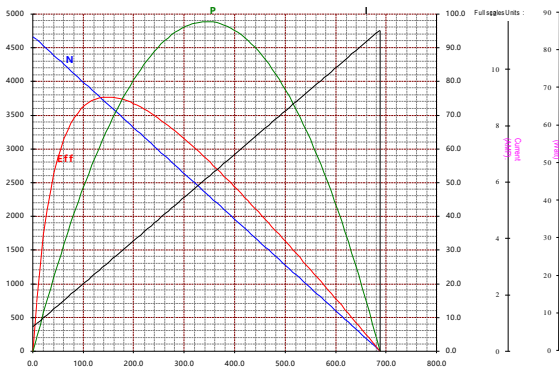

DM5685-36-080-03

