



### Specifications

Item	Unit	VA1305510-SB	VA13010010-SB	VA13010020-SB	VA13015010-SB	VA13015030-SB	VA13020020-SB	VA13030020-SB	VA13030030-SB
Rated Output	W	550.0	1000.0	1000.0	1500.0	1500.0	2000.0	3000.0	3000.0
Amplifier Type		TSTA30C	TSTA30C	TSTA30C	TSTA50D	TSTA50D	TSTA50D	TSTA75D	TSTA75D
Rated terminal voltage	V	162.30	189	185.30	194	200	205	189.4	199.7
Rated Torque	N m	5	10	5	14	5	10	14	10
Rated Current	A	3.4	5.2	5.2	7.5	7.1	9.2	14.0	14.00
Rated Speed	rpm	1000	1000	2000	1000	3000	2000	2000	3000
Peak Torque	N m	15.76	28.65	14.33	42.96	14.33	28.65	42.96	28.65
Peak Current	A	10	16	16	22	21	28	42	42
Torque Constant	N m/A	1.68	2.04	1.02	2.26	0.74	1.14	1.13	0.75
Voltage Constant	V/K rpm	176	214	107	237	78	119	118	79
Inertia ( GD2 /4)	Kg cm	6	12	6	18	6	12	18	12
Resistance	Ω	5.37	2.78	1.82	1.79	0.98	0.86	0.50	0.37
Inductance	mH	28	18	10	13	5	6	4	2
Mechanical Time Constant	ms	1.210	0.820	1.110		1.14	0.81	0.71	0.81
Electrical Time Constant	ms	5	7	6	7	5	7	7	7
Weight ( standard)	Kg	6.47	10.18	6.47	13.87	6.47	10.18	13.87	10.18
Speed Detector	Optics Encoder(INC: 2000P/R, ABS: 2048P/R)								
Time	Continuous								
Insulation class	B Class (1300C)								
Insulation Voltage	AC 1500V at 1 minute								
Insulation resistance	DC 500V Above 10 MΩ								
Structure	Fully closed								
Shockproofness	Below 2.5G								
Altitude	Under 1000m								
Temperature Humidity	Temperature: 0~40, Humidity: Below 90%RH ( No Frosting)								
Temp. Humidity for storage	Temperature: -20 ~60, Humidity: Below 90%RH ( No Frosting)								
Color	N 1.5								
Fixing Mode	Flange								

### Outline Drawing

Motor Type	With Brake	Without Brake
	L (mm)	L (mm)
VA1305510-SB	217.8	164.8
VA13010010-SB	267.8	214.8
VA13010020-SB	317.8	264.8
VA13015010-SB	217.8	164.8
VA13015030-SB	267.8	214.8
VA13020020-SB	317.8	264.8
VA13030020-SB	217.8	164.8
VA13030030-SB	267.8	214.8

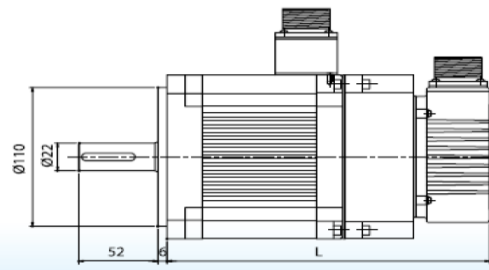
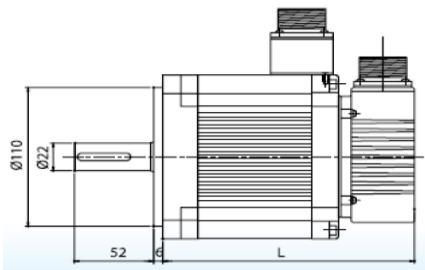
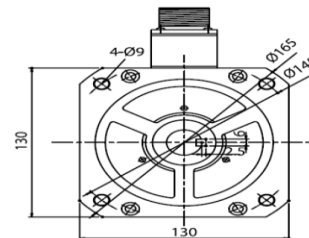

# Performance Curve

